

POWER GRID COMPANY OF BANGLADESH LIMITED

Bidding Document

For

Procurement of

Design, Supply, Installation, Testing and Commissioning of new 400/230/132 kV GIS SS at Korerhat and Upgradation of 230/33 kV Substation to 400/230/33 kV GIS at Mirsharai

[Contract No.: PGCB/WB/ESPNERP/GIS/P4]

Addendum 02

Following changes/revisions are made in the bidding document which will form part of the bidding document.

1. Volume 2 of 2, Section 20, 20.2 List of Bid Drawings

"Drawing No. 39. Korerhat Property Line & Security Wall" of 20.2.1 Korerhat Substation Drawing List and "Drawing No. 26. Mirsharai Property Line & Security Wall" of 20.2.2 Mirsharai Substation Drawing List are revised and attached as **Attachment 1**.

2. Volume 2 of 2, Section 20, 20.2 List of Bid Drawings

"Drawing No. 41. Korerhat Internal Road" of 20.2.1 Korerhat Substation Drawing List and "Drawing No. 28. Mirsharai Internal Road" of 20.2.2 Mirsharai Substation Drawing List are revised and attached as **Attachment 2**.











Attachment 1 of Addendum 02

A

~~SK~~

BR

~~BR~~

JK

Alm

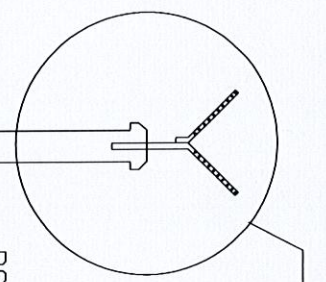
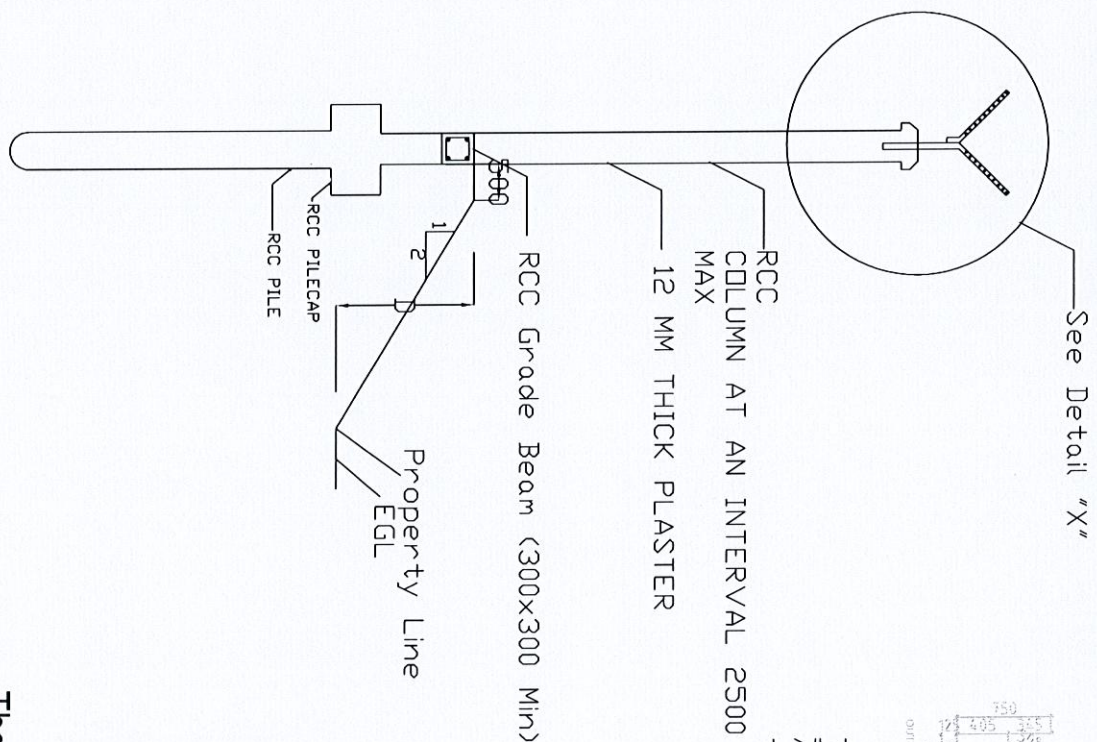
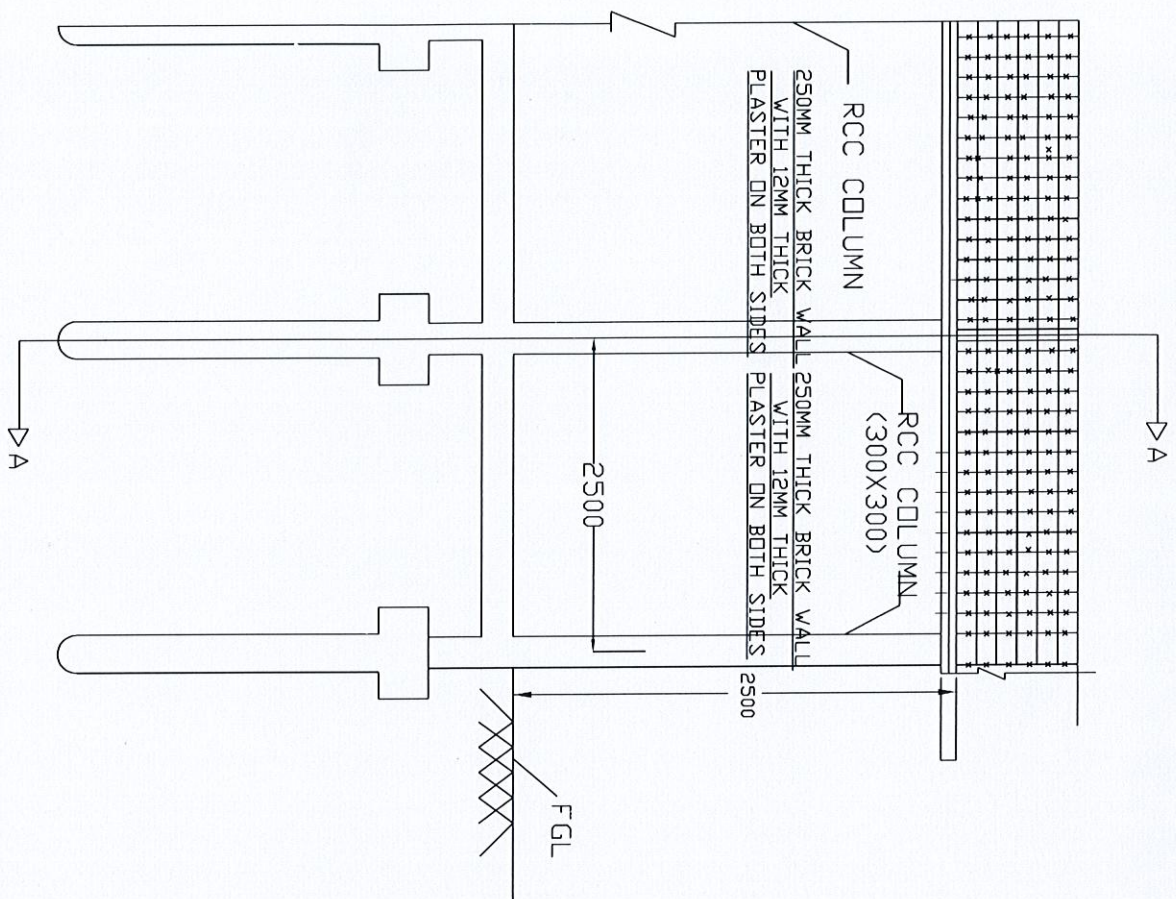

Detail "X"

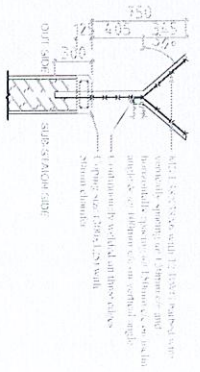

NOTE:
 (1) "EGL" means Existing Ground Level
 (2) "FGL" means Finished Ground Level
 (3) DIMENSIONS ARE IN MM
 (4) "D" = Depth of Earth Filling for Land Development
 (5) Expansion Joints shall have to be provided at 25m Interval.
 (6) Length of pile will be as per geotechnical investigation report during execution.

The drawing is Preliminary & is for Bidding Purpose Only

Power Grid Company of Bangladesh Limited
 Project: Design, Supply, Installation, Testing and Commissioning of new 400/230/132 KV GIS SS at Korumat and Upgradation of 230/132 KV Substation to 400/230/132 KV GIS at Mirsharai

| Drawing Title | |
|---------------|----------|
| Boundary wall | |
| Drawing No. | |
| Drawn | Checked |
| | Approved |

Attachment 2 of Addendum 02

A

~~sk~~

am

~~7~~

Alu

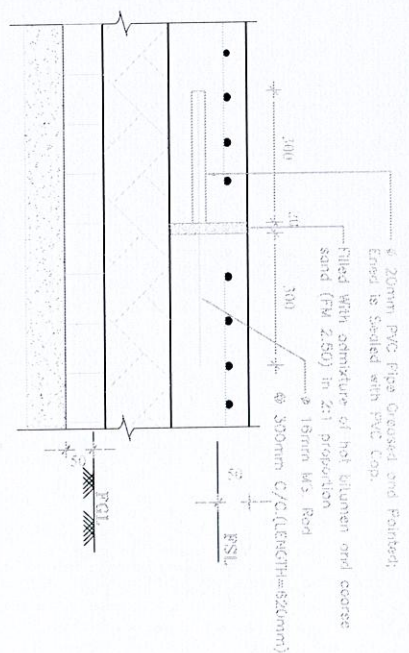

KEY PLAN OF INTERNAL ROAD (SCALE - NTS)

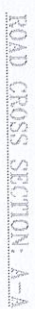

ROAD CROSS SECTION: A-A

The drawing is Preliminary & is for Bidding Purpose Only

| | |
|---|--|
| | Power Grid Company of Bangladesh Limited |
|---|--|

Project Design, Supply, Installation, Testing and Commissioning of new 400/230/132 kV GIS 55 at Kororhah and Upgradation of 230/33 kV Substation to 400/230/33 kV C at Mirsharai

| Drawing Title | RCC Road |
|---------------|----------|
|---------------|----------|

Drawing No.DrawnChecked _____Approved _____